



Brateck

LDT49 Series

Premium Slim Aluminum Spring-Assisted Monitor Arms

Featuring **slim arms and outstanding flexibility**, the LDT49 Series Monitor Arms combine great looks and smooth movement resulting in a better work experience. Ideal for applications requiring frequent display adjustments, including financial analysis, creative work and more.



LDT49 Series

Premium Slim Aluminum Spring-Assisted Monitor Arms

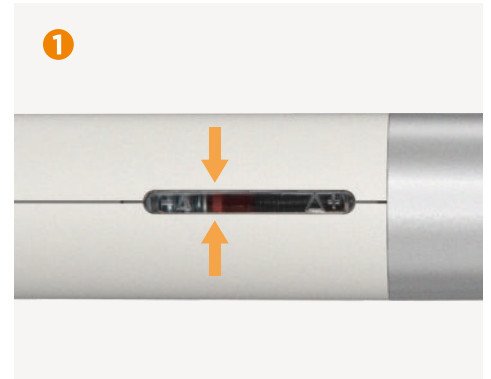

Attention to Details

- 1 Tension Indicator**
designed for spring tension alignment when installing multiple monitors
- 2 Built-in Spring Gauge**
for perfect weight adjustments
- 3 Quick-Release VESA Plate**
allows for effortless installation and removal
- 4 Rotation Stop**
selectable 180°/360° movement to avoid hitting walls or partitions

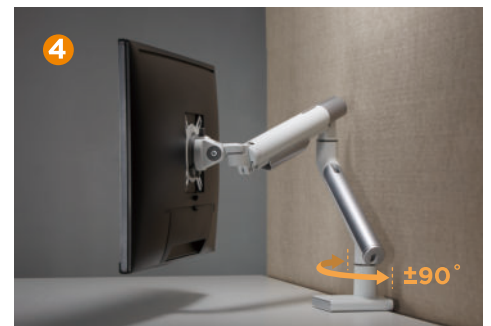

LDT49 Series

Premium Slim Aluminum Spring-Assisted
Monitor Arms



Single Monitor

- LDT49-C012
- LDT49-C012U 2 x USB 3.0 Ports

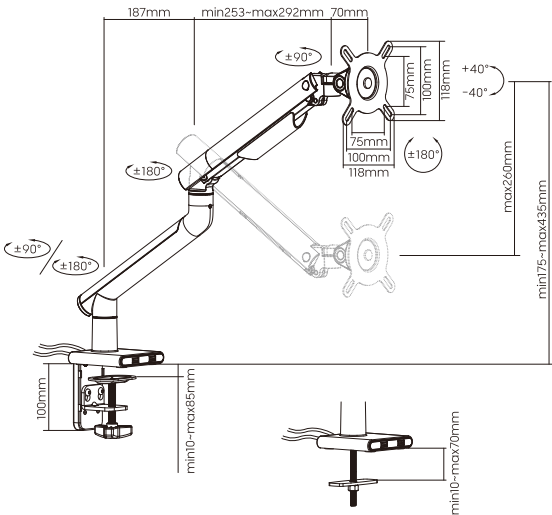

Dual Monitor

- LDT49-C024
- LDT49-C024U 2 x USB 3.0 Ports

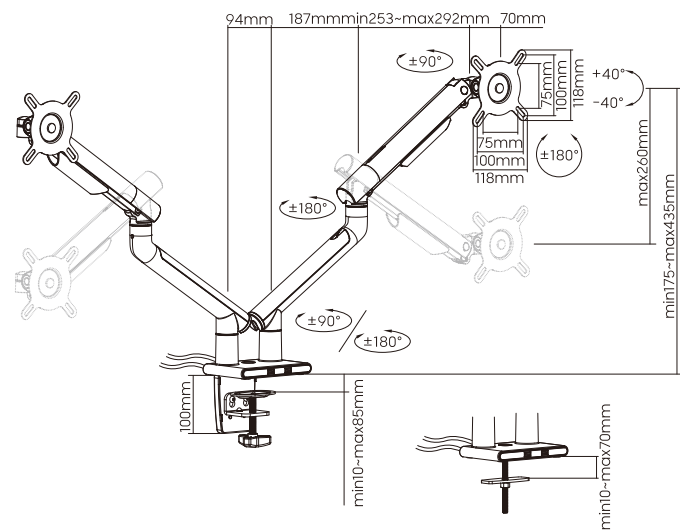

Colors: ☐ ☒

Item No.	LDT49-C012/LDT49-C012U/LDT49-C024/LDT49-C024U
Screen Size	17"-32"
Weight Capacity(per screen)	2-9kg/4.4-19.8lbs
VESA Compatible	75x75, 100x100
Tilt Range	+40°--40°
Swivel Range	+90°--90°
Screen Rotation	+180°--180°
Material	Aluminum, Steel, Plastic